

EPIC® SIGNAL R3.0

High-density circular connectors for signal applications



The EPIC® SIGNAL R3.0 series of circular connectors is an extension to the EPIC® SIGNAL M23 series when additional contacts are required.

Parts are specified separately but sold assembled. Always use combination part number when ordering.

Technical data

Number of contacts:	21, 26	Mating cycles:	500 (higher mating cycles depends on the application)
Temperature range: - short term:	-40°C to +100°C up to +125°C	Material:	
Rated voltage:	24V AC / 60V DC	- housing:	nickel-plated copper alloy
Rated current:	7.5A	- insulation body:	thermoplastic, V-0 per UL 94
Test voltage:	1.5 kV AC	- contacts:	gold-plated copper alloy
Protection class:	IP65/67 when mated DIN 40050 (depending on cable gland used)	- gaskets:	neoprene
Wire gauge - solder contacts:	up to 18 AWG (1 mm ²)	Contact resistance:	< 3 mΩ
Cable diameter:	6.5 - 16 mm		

Combination part numbers

Always use combination part number when ordering.

Example:

20.2040AF (housing) + 40.200121 (insert) =
00009045 (combination)

Housing part number	21 contact inserts		26 contact inserts	
	male 40.200121	female 40.250121	male 40.200126	female 40.250126
	Connectors			
202040AF	00009045	00008749	00008899	00008829
202050AF	00008854	00008779	00008822	00008979
	Panel mount sockets			
202010AA	00008747	00008867	00008825	00008746
202020AA	00009082	00009135	—	00008978
202030AA	—	—	—	00009470
202060AA	00009371	00009057	00009894	00009005

EPIC® SIGNAL R3.0 accessories & tools

metal screw cap



flat gasket



sealing ring



assembly tool



Size	Part number
A	50201120

Size	Part number
A	50201203
B1, B2	50202203

Size	Part number
G1	50206204

Size	Part number
D6, F6	50200800

If not otherwise specified, all values relating to the product are nominal values. Photographs are not to scale and are not true representations of the products in question.

EPIC® SIGNAL R3.0 style D6

Cable connector; 202040AF

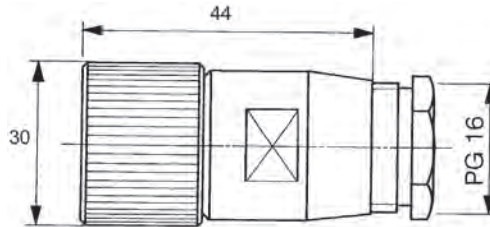

all dimensions are in mm

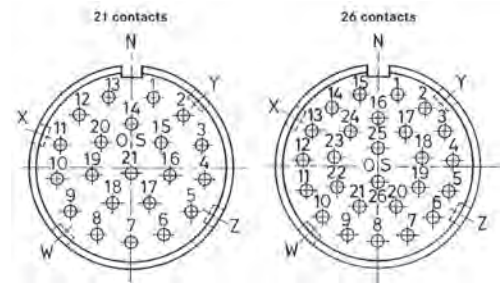

Number of contacts	Part number	
	male (E)	female (P)
21	00009045	00008749
26	00008899	00008829

Complete the installation



Assembly tool:
50200800

EPIC® SIGNAL R3.0 style F6

Cable connector; 202050AF

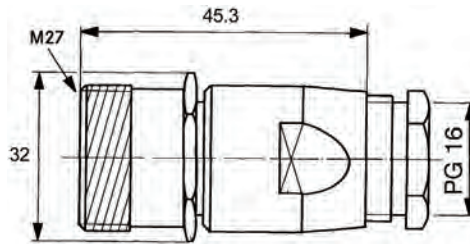

all dimensions are in mm

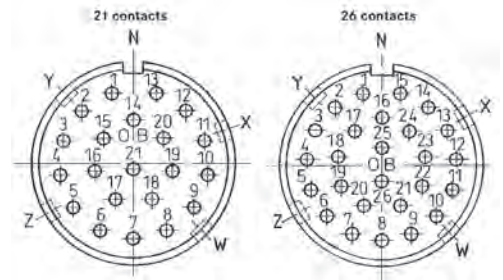

Number of contacts	Part number	
	male (E)	female (P)
21	00008854	00008779
26	00008822	00008979

Complete the installation



Assembly tool:
50200800

EPIC® SIGNAL R3.0 style A

Front wall mounting; 202010AA

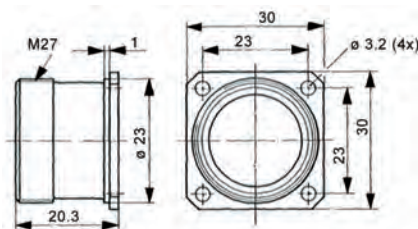

all dimensions are in mm

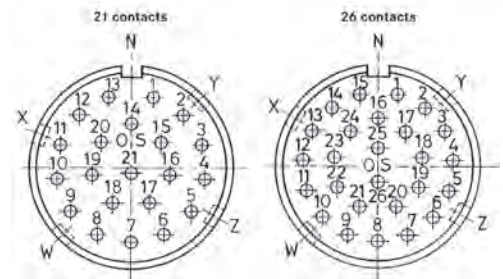

Number of contacts	Part number	
	male (E)	female (P)
21	00008747	00008867
26	00008825	00008746

Complete the installation



Screw cap:
50201120



Flat gasket:
50201203

If not otherwise specified, all values relating to the product are nominal values. Photographs are not to scale and are not true representations of the products in question.

EPIC® SIGNAL R3.0 style B1

Inside of panel mounting; 202020AA

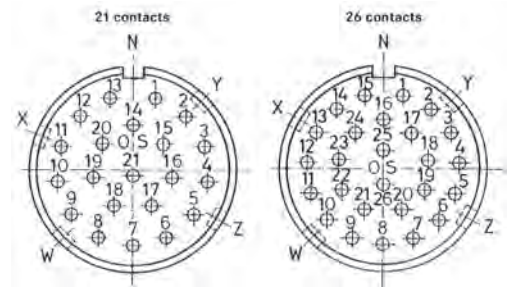
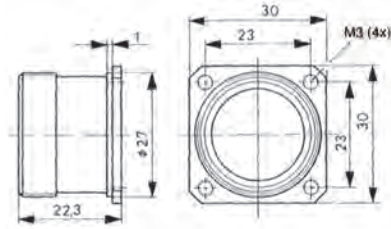

Number of contacts	Part number	
	male (E)	female (P)
21	00009082	00009135
26	—	00008978

Complete the installation



Flat gasket:
50202203

EPIC® SIGNAL R3.0 style B2

Inside of panel mounting; 202030AA

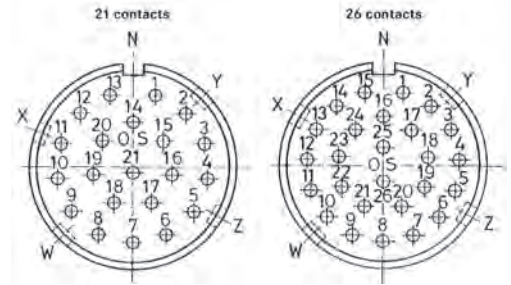
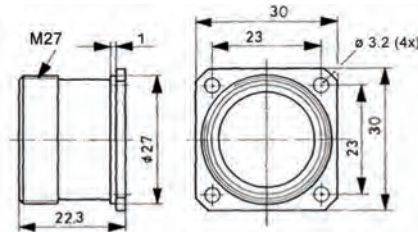

Number of contacts	Part number	
	male (E)	female (P)
21	—	—
26	—	00009470

Complete the installation



Flat gasket:
50202203

EPIC® SIGNAL R3.0 style G1

Inside of panel with locknut; 202060AA

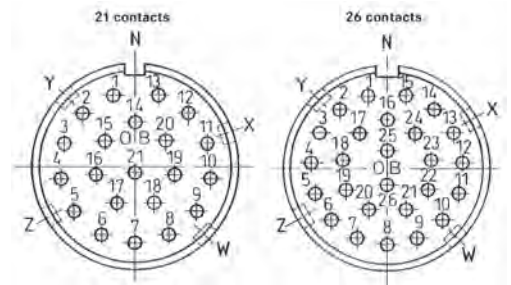
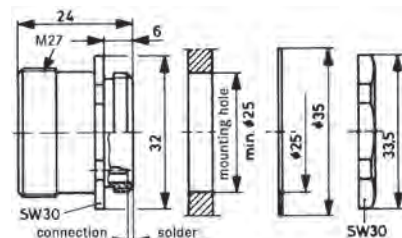

Number of contacts	Part number	
	male (E)	female (P)
21	00009371	00009057
26	00009894	00009005

Complete the installation



Sealing ring:
50206204